

2003 Annual Report

Huntingdon County Planning Commission

March 2004

Inside this issue:

Agency Organization and Management	2
Work Program	2
Comprehensive Plan Development	4
Enterprise Zone	5
Coordination	6
County-Municipal Project Review	7
Federal-State Project Review	8
Subdivision and Land Development Reviews	8
Municipal Planning and Development Assistance	10
County Planning and Development Assistance	11
Huntingdon County GIS	11
911 and Rural Addressing	11
CDBG Three Year Plan	13
Subdivision Activity	14
Deed Transfers	15
Building Activity	15
Seasonal and Year-Round Housing	16
Public Education and Information	17

PURPOSE OF THE PLANNING COMMISSION - MISSION STATEMENT

It is the mission of the Huntingdon County Planning Commission to develop and implement a positive vision for Huntingdon County; one that reflects economic prosperity, a rural and small-town atmosphere,

protection of natural resources, centers-focused development, greenway corridors, improved highway and communication access and a high standard of excellence in both personal and community development.

The Planning Commission and the Huntingdon County Planning and Development Department assist the County in meeting these important goals.

Leadership Huntingdon County Enrolls Nineteen in Class

Members of the Class of 2004 met with community supporters at the Lake Raystown Resort on September 9th to kick off Leadership Huntingdon County. The nineteen members of the Class of 2004 represent a wide range of professions and communities

judicial", "arts and culture," and "health, housing and human services".

community change through the development of community leaders.

The mission of Leadership Huntingdon County is to stimulate positive

The Kick-off Dinner was followed by a Retreat and monthly Thursday evening meetings. The retreat focused on building leadership skills. Each leadership event focuses on a different community issue. The focus of the first session was "local government, demographics and planning". Later sessions focused on "legal and



Leadership Huntingdon County - Class of 2004

AGENCY ORGANIZATION AND MANAGEMENT

PLANNING COMMISSION

The Huntingdon County Commissioners created the Huntingdon County Planning Commission in 1962 and hired the first planning director in 1971. The County Commissioners have directed the Planning Commission to prepare and maintain a comprehensive plan to guide growth and development in the County and to promote public interest in and understanding of planning and the *Comprehensive Plan*. Volunteers, staff, money and equipment are the resources needed to achieve the objectives of the Huntingdon County Planning Commission.

In 2003, Larry Pruss attained 20 years of service on the Planning Commission. Current Member's Years of Service are as follows:

16 to 20 Years

Larry Pruss Ginny Gill

11 to 15 Years

Ann Reynolds Millie Rockwell

6 to 10 Years

Larry Mutti

1 to 5 Years

Herb Cole Ron Rabena
Carl Jaymes Greg Schneider

STAFFING

Cinnamon Bair and Timothy Nabozny were hired in April to assist Brian Young in completing the 911 Addressing Project. They replaced two technicians who had resigned for other employment.

Three interns worked for the Planning and Development Department in 2003: Wendy Covert, a Hagerstown Business School student; Kristin Corbin, a Geneva

College student; and Megan Summers, a JTPA summer worker.

During the year, staff participated in numerous training workshops and conferences to enhance their skills. Major conferences included the Pennsylvania Planning Association Annual Conference, the GIS Annual Conference, the CDBG Annual Conference, and the Governor's Conference on Integrating Transportation and Land Use for Economic Development.

WORK PROGRAM

Municipal Waste Management Plan

Huntingdon County has joined once again with Bedford and Fulton Counties to develop a plan for the management of solid waste. Bedford County is managing funding for the Plan and Gannett Fleming has been retained to develop the Plan. A draft Plan will be completed in late 2004, with adoption by local municipalities in 2005.

Pennsylvania Act 101 requires counties to revise their Plans every ten years. Funding for the new Plan has been obtained from the Pennsylvania Department of Environmental Protection.

911 and Rural Addressing

It is expected that new addresses will be issued for Regions 3 and 6 and that field work will be completed for Regions 4 and 5 in 2004. Full implementation of the *Huntingdon County Street Naming and Addressing Policy* is expected by early 2005.

Community Development

The administration of Community Development and other grants will continue to be a major staff activity. Work expected during the year includes development of the entitlement grant application, development of a competitive grant

application for the Broad Top City and Dudley Water Systems, development of a Three Year Community Development Plan and administration of numerous funded activities.

Enterprise Zone

The Planning and Development Department will support the Enterprise Zone by annually applying for administrative funding from the Department of Community and Economic Development and monitoring implementation of the Zone by JCEL.

LUPTAP and Shared Municipal Services Grants

Planning staff expects to apply for a LUPTAP grant to continue development of the County Comprehensive Plan and for a Shared Municipal Services grant to assist municipalities in purchasing additional street signs.

Geographic Information System

Development of GIS information for Huntingdon County will focus on implementation of a second grant from the Pennsylvania Department of Agriculture to fund conversion of County Tax Maps to a digital basis. Additional work will include creation of detailed maps for water and sewer systems and updating existing data. The Spatial Sciences Research Center at Indiana University of Pennsylvania will continue to assist the County.

FINANCIAL REPORT

During 2003, the operation of the Department was funded through the County General Fund (\$99,812.00) and through several state and federal government grant programs (\$229,300.00).

The 2004 General Fund budget increased by 3.99% from 2003; and the 2004 budget for Grants and Special Projects increased by 3.45%.

Project. Overall, the 2004 budget is 3.61% higher than it was in 2003.

This increase in Grants is because more money has been allocated for 911 and the Street Naming and Addressing

General Fund Budget Report

Grants and Special Projects Budget Report *

	2003 Budget	2003 Expenditures	2004 Budget		2003 Budget	2003 Expenditures	2004 Budget
Personnel	\$79,972.00	\$79,700.65	\$82,498.00	Personnel	\$136,384.00	\$130,289.57	\$136,209.00
Services	\$16,700.00	\$16,580.25	\$16,800.00	Services	\$32,050.00	\$17,964.16	\$29,400.00
Materials & Supplies	\$2,000.00	\$2,425.08	\$2,500.00	Materials & Supplies	\$7,600.00	\$1,878.13	\$3,600.00
Capital Outlay	\$1,140.00	\$81.98	\$2,000.00	Other	\$53,266.00	\$27,535.18	\$68,000.00
Total	\$99,812.00	\$98,787.96	\$103,798.00	Total	\$229,300.00	\$177,667.04	\$237,209.00

Grant & General Fund Totals

*Grants and Special Projects include Community Development Block Grant funds used for administrative purposes.

2003 Budget	2003 Expenditures	2004 Budget
\$329,112.00	\$276,455.00	\$341,007.00

2003 Grant and General Fund Expenditures

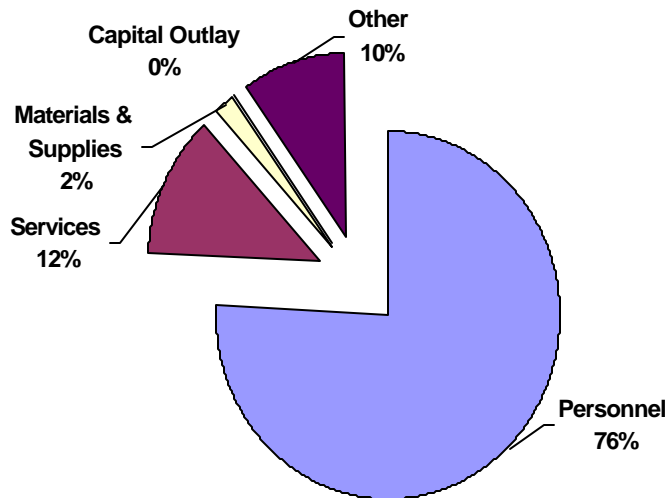

COMPREHENSIVE PLAN DEVELOPMENT

IUP Completes Demographic Analysis

The Indiana University of Pennsylvania Spatial Sciences Research Center assisted the Department in further analyzing the 2000 Census data and recent demographic trends. The "Population and Demographics" section of *Phase I, Background Studies* was completely revised, and a number of thematic maps were developed to illustrate trends within the County and the State

IUP has been under contract to the County for a number of years, assisting the County with GIS and mapping related tasks.

Thematic maps produced include maps showing the county and its minor civil divisions (mcd), the Central Pennsylvania Area by mcd, and the Commonwealth of Pennsylvania by county. Samples of county and statewide maps are shown here.

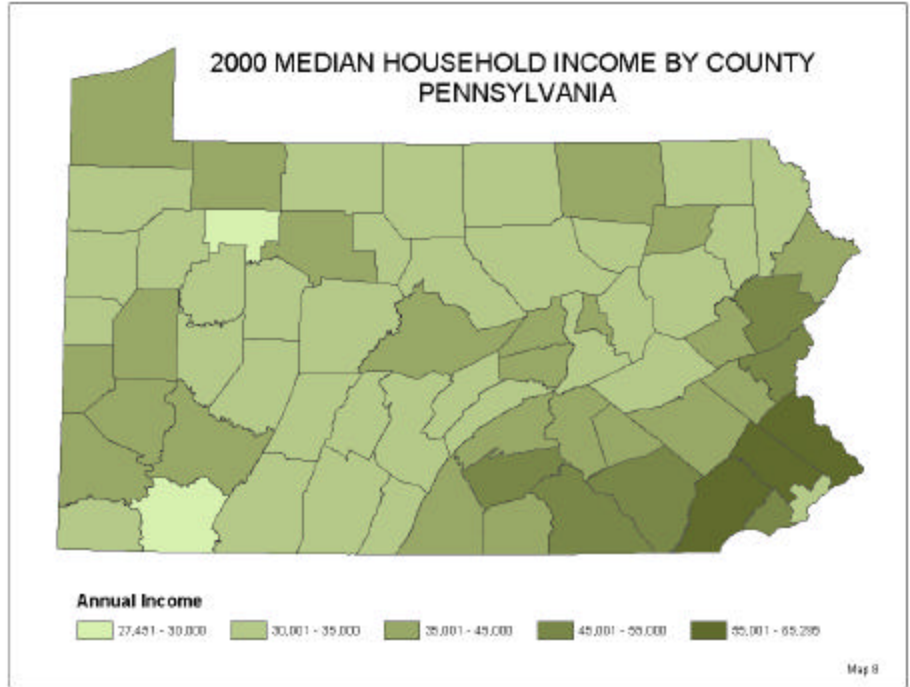

Huntingdon County is generally younger than Pennsylvania, and older than the United States. The bar chart below shows a population breakdown for the U.S., Pennsylvania, and Huntingdon County by percentage over grouped age cohorts.

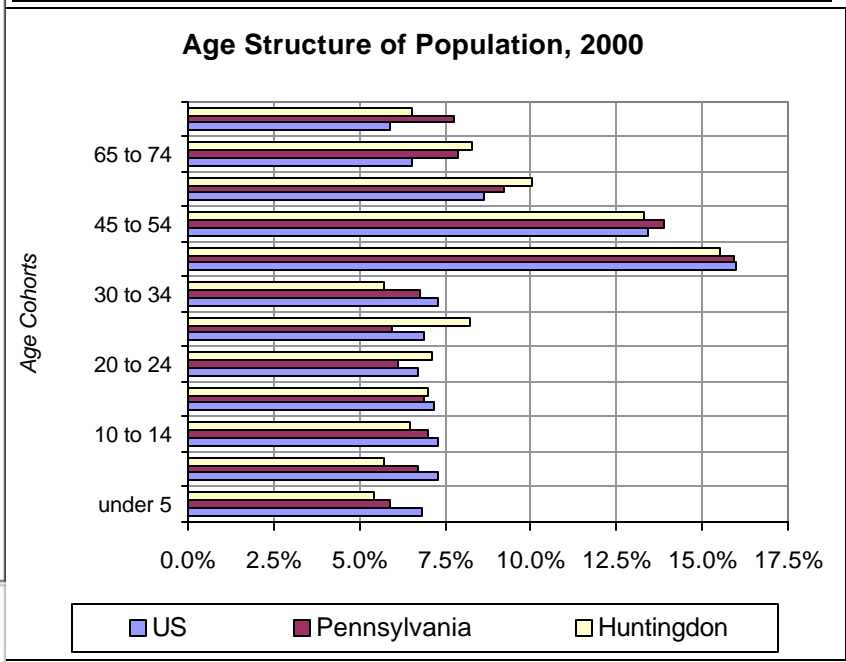
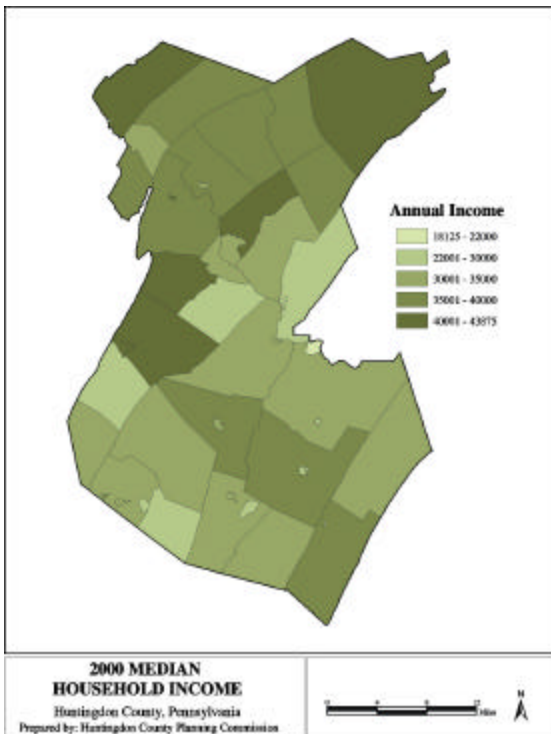

Planning Commission Tours Raystown Field Station

The members of the Planning Commission shared a picnic meal and a tour of the "green" Shuster Hall in June. Chuck Yohn, Director of the Raystown Field Station, led Commission members and staff through the first building of the new Field Station prior to the monthly Planning Commission meeting.

Juniata College has incorporated energy efficient features, building materials from the region, composting toilets and various other environmentally friendly features into the building. The design has been submitted to the United States Green Building Council via the Leadership in Energy and Environment Design Green Rating System for certification as a "green" building.



Front Row (left to right): Ginny Gill, Ann Reynolds, Millie Rockwell, Larry Mutti
Back Row (left to right): Carl Jaymes, Ron Rabena, Gregory Scheneider, Larry Pruss, Herb Cole

Enterprise Zone Approved, Expanded

A May 2nd letter from the Secretary of Community and Economic Development approved a Huntingdon County Enterprise Zone. This capped a two-year economic development effort by the Huntingdon County Commissioners that included development of the *Huntingdon County Comprehensive Economic Analysis*.

The Planning and Development Department developed the New Communities Grant application on behalf of the County Commissioners. The May Enterprise Zone approval lead to a \$50,000 grant to fund an Enterprise Zone Coordinator.

A request for expanding the Enterprise Zone was filed by the Planning and Development

Department and approved by the State on January 7, 2004. The completed Enterprise Zone involves 1,568 acres in ten municipalities, stretching from Mount Union to Alexandria.

The Huntingdon County Commissioners have contracted with Juniata College's Center for Entrepreneurial Leadership Center (JCEL) to provide the services of Enterprise Zone Coordinator. JCEL also serves as staff for Huntingdon County Business and Industry.

The Enterprise Zone provides two principle benefits for business, a 20% tax credit against the state corporate net income tax and low interest loans to businesses locating in the Zone.

County Launches Homeownership Program

The Department implemented a goal of the *Comprehensive Plan's Housing Plan* in 2003 by initiating a new First Time Homebuyer Program.

The *Comprehensive Plan* identified down payments as a frequent impediment to homeownership. The Program meets this need by providing up to \$6,500 toward down payment and closing costs for low and moderate income households.

Grant funds are available to assist with the purchase of 11 houses. Participants are being selected in two groups. The first six participants are from Warriors Mark, Wood, Smithfield and Penn Townships and Huntingdon Borough. They are pre-qualified by area banks for mortgages averaging \$67,000, and have 12 months from the date of acceptance into the Program to purchase a home.

Program implementation involves coordination with a number of parties including the Penn State Cooperative Extension Office for homebuyer education; Huntingdon County Housing Services for home inspections; and area lending institutions and realtors.

COORDINATION

Coordinating the implementation of the *Huntingdon County Comprehensive Plan*, with public and private organizations, is achieved through the following four processes: Agency Liaison, County-Municipal Project Review, Federal-State Project Review and Subdivision and Land Development Reviews.

AGENCY LIAISON

The Planning Commission and its staff coordinate the implementation of planning recommendations with many agencies and units of government. This includes staff participation in many committees and attendance at numerous meetings.

Juniata College Center for Entrepreneurial Leadership (JCEL)

Staff has worked closely with JCEL this year. JCEL serves as Enterprise Zone Coordinator for the County Commissioners and serves as staff for HCB&I.



Juniata College has taken a proactive approach to business education, seeking to involve students in experiential learning. JCEL has created a student seed capital fund to develop student operated businesses and the Bob and Eileen Sill Business Incubator to support new businesses. The Business Incubator is expected to open during the summer of 2004.

Huntingdon County Business and Industry (HCB&I)

The Planning Director continues to serve on the HCB&I Industrial Development and Transportation Committees. The Grant

Administrator has also been working closely with HCB&I while developing a more dependable water source for the Mount Union Area.

Juniata Clean Water Partnership (JCWP)

The Planning Director sits on the Partnership Board and served as President for 2003.

The JCWP took several actions last year designed to assure implementation of the *Juniata Watershed Management Plan*:

- Established a watershed resource center;
- Restructured, Incorporated and formed a 24 member Board of Directors;
- Received nonprofit status from the IRS; and
- Began a search for a new Watershed Projects Manager.

The seven counties that participate in the Partnership are: Bedford, Blair, Fulton, Huntingdon, Juniata, Mifflin and Perry; along with regional groups, such as the Allegheny Ridge Corporation, Susquehanna River Basin Commission, Westsylvania Heritage Corporation, Western Pennsylvania Conservancy, Trout Unlimited and the Rural Communities Assistance Program

Agricultural Land Preservation Board

Late in the year, the Preservation Board received approval from the State Agricultural Board for purchase of an agricultural conservation easement on a 100 acre farm in Brady Township.

Planning staff continued to work closely with the Huntingdon County Agricultural Land Preservation Board and County Conservation District staff to implement an agricultural land preservation

program. Staff used GIS data to rate two additional farms for participation in the program.

Housing Advisory Committee

The Department continued to support a Housing Advisory Committee comprised of bankers, real estate firms and public housing agencies. The Committee meets quarterly to share information on housing programs, particularly those that benefit low and moderate income persons.

Southern Alleghenies Planning and Development Commission (SAPDC)

The Planning Director represents the County on several Southern Alleghenies committees: Planning Advisory Committee (PAC); DSF Committee; Transportation Technical Committee (TTC); and Tourism Confederation. The Planner/GIS Technician is a member of the GIS Users Group (GUG) and the County Commissioners sit on the Executive Committee.

Southern Alleghenies provides planning, economic development and job training services to a six-county area including Huntingdon County.

Major activities carried out during 2003 included: participation in the Municipal Technical Assistance Program (MTAP) and completion of the I-99 Transportation and Community System Preservation Project (TCSP). The TCSP project provided the Department with new GIS software and training. The Transportation Technical Committee met frequently during the year to develop a regional Transportation Improvement Program.

Southern Alleghenies provided financial assistance to the County through three programs in 2003: TSCP I-99, PennSTEP and the Municipal Technology Assistance Program (MTAP). The TSCP I-99 program provided funds for the purchase of GIS technology. The PennSTEP program provided \$5,040 for waterline replacement in Mapleton Borough; \$4,960 for supplemental well development in Petersburg Borough; and \$10,000 for wastewater collection flow monitoring equipment for Walker Township. The MTAP program provided funds for coordination of technology purchase by local municipalities.

Huntingdon County Heritage Committee

The Planning Director and Nancy Shedd, Executive Director of the Huntingdon County Historical Society, continue to co-chair the Heritage Committee. Planning staff assisted the Heritage Committee in setting up and staffing a booth at the Westsylvania Outdoor Heritage Festival, held at the Huntingdon County Fairgrounds.

COUNTY-MUNICIPAL PROJECT REVIEW

Section 303 of the PA Municipalities Planning Code (Act 247) gives the Planning Commission the authority to review and comment on various public facility projects, zoning, subdivision and other land development ordinances.

Local government and state agencies submitted the following 27 projects to the Commission for review and comment in 2003:

1. Roadway Safety Improvements, Route 26, Section 016, Miller Township
2. Warriors Mark Subdivision and Land Development Ordinance Amendment
3. Tell Township Agricultural Security Modification/Addition
4. Cromwell Township Sewage Treatment Plant and Collection Facilities
5. Huntingdon Hospitality, Inc., Huntingdon Borough, proposed hotel and parking
6. Alexandria Borough, DCNR Recreation Grant, Proposed Playground
7. Proposed Mead Warehouse Expansion, Porter Township
8. Gerald E. Booher, Cromwell Township, fill along creek at intersection of Blacklog Creek and Aughwick Creek
9. Calvary Independent Baptist Church, Huntingdon Borough, construction of a 26,000 square foot multi-purpose building
10. PennDOT, Cromwell Township, SR 0522, Section 07M, super- and substructure repairs to the single span pre-stressed concrete spread box beam bridge over Craig's Run
11. PennDOT, Cromwell Township, SR 0522, Section 5BN, realignment of an approximate one mile section which runs parallel to Blacklog Creek
12. Park's Transfer Station, Shirley Township - Radiation Protection Action Plan
13. Stone Valley Welding Shop, construction of new building, parking area and storage areas
14. SR 522 Improvement Project, Proposed Fill Site on EBT Property
15. New Enterprise Stone & Lime Co., Inc., Spruce Creek and Warriors Mark Townships, request to increase approved pit depth from the 820 foot to 650 foot elevation
16. Intersection of SR 0026 and SR 3035, Walker Township, Safety Improvements
17. Lake Raystown Resort, Environmental Review
18. Runk Shale Pit, Todd Township
19. Jackson Corner Slide, PA 26, Environmental Review
20. Blaine A. Opton Zoning Consistency Review, Smithfield Township, change in use of M&M Restaurant location
21. Cromwell Township Agricultural Security Area Expansion
22. Warriors Mark Township Agricultural Security Area Expansion
23. Porter Township Agricultural Security Area
24. West Township Agricultural Security Area
25. Alexandria Borough Municipal Authority, Water Treatment Facility
26. SR 26, Section 23 Safety Improvements (SR3011 Intersection), Penn Township
27. Juniata Valley High School Stream Restoration Project, Porter Township

Additionally, Act 14 requires those applying for water obstruction permits, water quality permits, or air quality permits to notify County Commissioners and municipal officials of all requests for state permits. The Commission received 62 state permit activity notices in 2003.

FEDERAL-STATE PROJECT REVIEW

The Planning Commission reviews projects that use federal funds for consistency with the County Comprehensive Plan, under the authority of Executive Order #12372, in cooperation with the Southern Alleghenies Planning and Development Commission.

Under the state-based Intergovernmental Review Process (IRP), the Commission reviewed two projects in 2003:

1. The Progress Fund

This project involved a funding request of \$750,000 from the USDA Intermediary Relending Program to provide loans to small businesses located within the nine-county investment area.

2. Ben Franklin Technology Center of Central and Northern Pennsylvania

This project involved a funding request of \$95,000 from the USDA Rural Business Enterprise Program.

SUBDIVISION AND LAND DEVELOPMENT REVIEWS

Section 502 of the PA Municipalities Planning Code gives the Planning Commission authority to review and comment on subdivision and land development proposals submitted to local municipalities. The Commission also comments on consistency with Act 537, the PA Sewage Facilities Act.

The Commission reviewed 81 subdivisions in 22 municipalities in 2003, up by 1 since 2002. These included 10 major subdivisions, 55 minor subdivisions, 8 major land developments, and 8 minor land developments encompassing 537 lots and 6,254 acres. Maps illustrating distribution of these proposals are located on pages 8 and 9.

The largest subdivisions reviewed in 2003 were:

- the Lower 77 Subdivision with 77.06 acres and 24 lots in Warriors Mark Township;
- the Highlands Phase V Subdivision with 7.7 acres and 18 lots in Huntingdon Borough;
- the Blue Spruce Subdivision with 50 acres and 16 lots in Warriors Mark Township;
- the Hickory Ridge Phase I Subdivision with 157 acres and 15 lots in Franklin Township;
- the Hickory Ridge Phase II Subdivision with 133 acres and 12 lots in Warriors Mark Township; and
- the Stone Gables Subdivision with 207 acres and 12 lots in Cromwell Township.

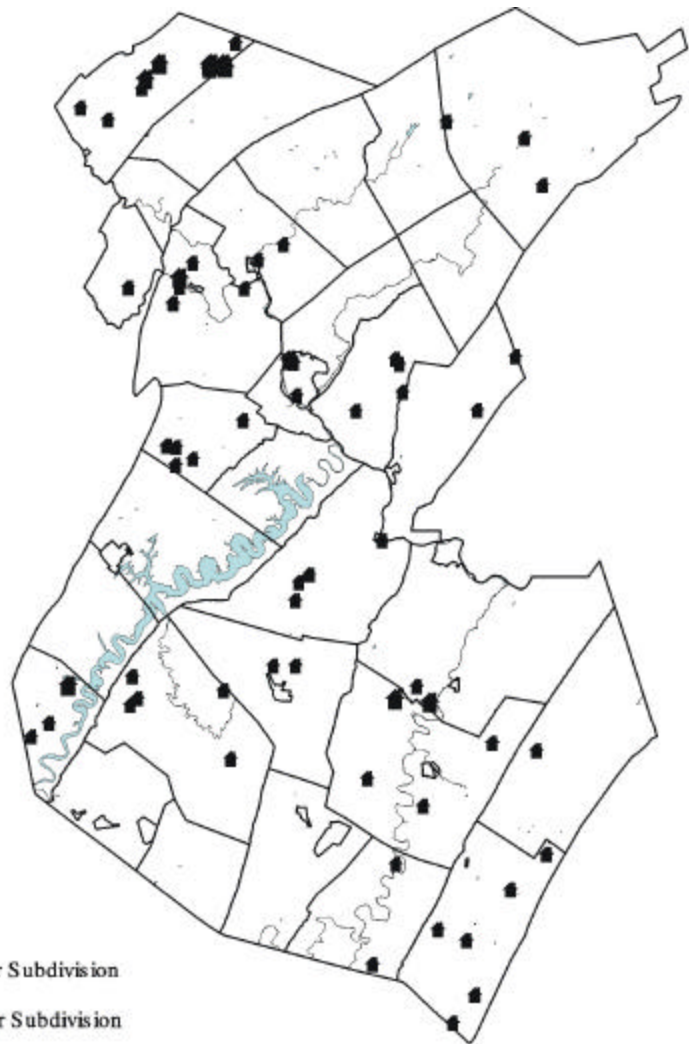

2003 Subdivision Activity
Huntingdon County, Pennsylvania
 Prepared by: Huntingdon County Planning Commission
 3/2/04



The eight major land development reviews conducted in 2003 included:

- Raspberry Ridge, Warriors Mark Township, construction of a 253 unit mobile home park;
- Bitter Goose Lodge, Todd Township, construction of 12 additional seasonal cabins on existing Lodge site;
- Valley Rural Electric Cooperative, Dublin Township, construction of 12,470 square foot office and maintenance building;
- Calvary Independent Baptist Church, Huntingdon Borough, construction of 20,220 square foot classroom/multi-purpose building;
- Canoe Valley Quarry, Morris Township, construction of a new surface mining operation;
- Meadwestvaco, Porter Township, construction of a 200,096 square foot addition;
- Huntingdon Storage and Distribution, LP, Smithfield Township, construction of a 240,000 square foot addition;
- Nehemiah Properties, LLC, Walker Township, construction of a 3,672 square foot apartment building

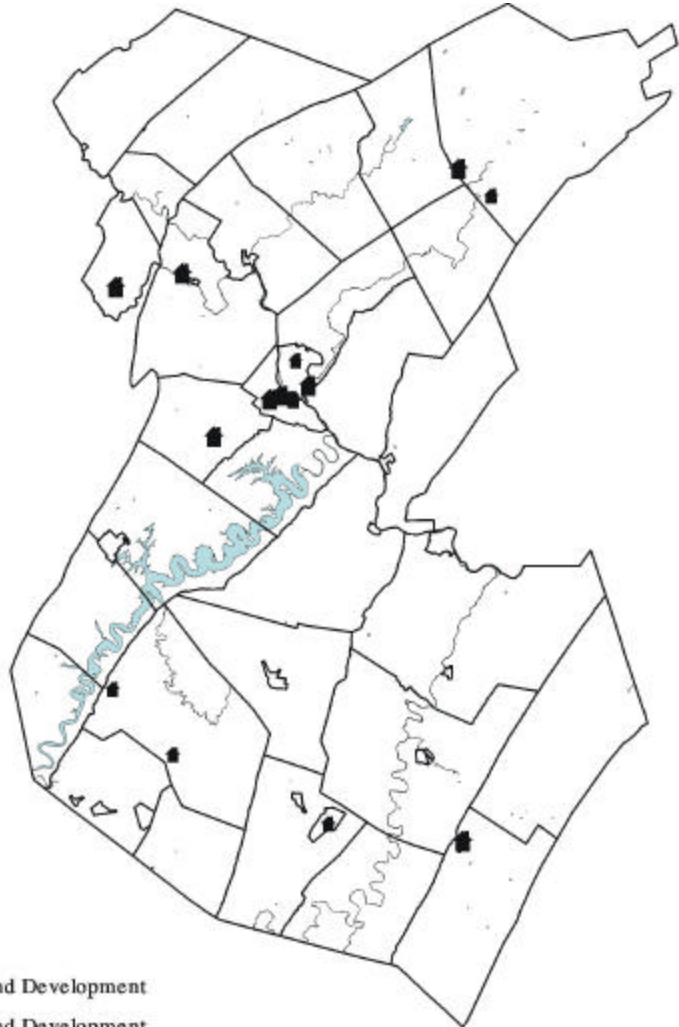

■ Major Land Development
■ Minor Land Development

2003 Land Development Activity Huntingdon County, Pennsylvania

Prepared by: Huntingdon County Planning Commission
3/2/04



MUNICIPAL PLANNING AND DEVELOPMENT ASSISTANCE

With the approval of the Huntingdon County Commissioners, the Planning and Development Department may provide assistance to municipalities that request it. Such assistance typically involves development of subdivision, zoning and building permit ordinances; grant applications and administration; requests for proposals for professional services; and various planning studies.

MUNICIPAL ASSISTANCE

Henderson, Miller and Spruce Creek Townships

- Staff met with members of the Township Supervisors and Planning Commissions to discuss customization and adoption of the County's Model Subdivision Ordinance.

Huntingdon Borough/Smithfield Township

- Staff and municipal representatives met with the Allegheny Ridge Heritage Corporation Executive Director to discuss funding for Portstown and Riverside Parks.

Mapleton Borough - Staff attending a public meeting regarding the condition of the municipal swimming pool and to discuss funding alternatives.

Morris Township - Staff met with the Township Planning Commission to discuss a proposed limestone quarry.

Mount Union Borough - Staff met with the Municipal Authority to discuss possible water source protection activities.

Union Township - Staff attended a Township Supervisor's meeting to discuss street naming and subdivision ordinance issues.

Warriors Mark Township - Staff cooperated with the Township Planning Commission and consultant Thomas R. Deans to begin an update of the Township's Comprehensive Plan and to discuss creation of a Township Zoning

Ordinance. At the Township's request, staff prepared maps of prime agricultural soils, structure locations, and tax parcels.

West Township - Staff met with a representative of the Township Supervisors to review a proposed Agricultural Security Area Application.

Model Subdivision Ordinance

- Planning and Development staff have been working with municipalities to customize the Ordinance for their use. Thus far, the Model Subdivision Ordinance has been adopted by five municipalities: Brady, Morris, Porter, Spruce Creek and Union Townships.

MTAP Program

- Alexandria and Mapleton Boroughs, Miller Township, and the Mapleton Municipal Authority participated in MTAP, receiving financial assistance to purchase computers, peripherals, software and internet services. Technical assistance, which included computer, software and peripheral installation, and on-site and telephone technical support, was provided to Alexandria Borough and Shirley, Todd and Walker Townships.

Computer training was provided for municipal officials in April and May. This training consisted of eight three-hour sessions on Microsoft Word and Excel, Introduction to Computers, and Introduction to the Internet. These training sessions were held at the DuBois Business College, Huntingdon, PA.

All Municipalities - Staff surveyed municipal officials to update a municipal contact database; provided an opportunity for participation in the Huntingdon County CDBG Entitlement Program; requested municipal financial support for a PA Council on the Arts Local Government Grant; determined interest in joint

planning and coordinated a multi-municipal planning workshop; and notified municipal officials about possible financial savings on computer equipment through the Pennsylvania Technology Investment Authority Program.

GRANT ASSISTANCE

The Department assists municipalities and non-profit organizations in meeting community development needs by applying for and administering various state and federal grants, including the Community Development Block Grant (CDBG) Entitlement Program which provides approximately \$300,000 annually.

A total of \$3,021,007 in CDBG and miscellaneous grants was received from 2001 through 2003.

During 2003, staff submitted a successful application for \$227,000 in Temporary Assistance to Needy Families (TANF) funds to supplement existing housing initiatives already funded through a 2002 HOME grant. TANF initiatives include owner occupied housing rehabilitation, repairs to First Time Homebuyer houses, and Minor Home Repairs averaging \$5,000 per house.

Huntingdon County contracts with Huntingdon County Housing Services, previously Weatherization, Inc., for the administration of HOME grant funds and housing rehabilitation services.

CDBG activities completed during 2003 include Broad Top KOEZ Infrastructure Construction, and Shirley Home Roof and Door Replacements. Easements were gathered and construction began on the Dudley-Carbon-Coalmon Sanitary Sewer System Project.

COUNTY PLANNING AND DEVELOPMENT ASSISTANCE

Many Department activities are countywide in nature and benefit all municipalities equally. Some activities are done to assist the County Commissioners in non-planning areas. Major Planning projects in 2003 included:

PARTNERSHIP FOR ECONOMIC PROGRESS

The Planning Director conducted a strategic planning process for the Huntingdon County Economic Development Task Force, which was created by the County Commissioners in 2000. After completion of the Strategic Plan, the Task Force voted to become the Huntingdon County Partnership for Economic Progress (PEP).

The role of the Partnership is to "encourage economic development in Huntingdon County".

LEADERSHIP HUNTINGDON COUNTY

The Department is deeply committed to the success of Leadership Huntingdon County, a goal of PEP. The Planning Director serves on the Leadership Committee of PEP and is one of nineteen members of the Class of 2004

With the assistance of the Department, the County received two grants to support the community leadership program, a \$5,000 Community Revitalization Grant from DCED and a \$10,000 grant from the Appalachian Regional Commission.

HUNTINGDON COUNTY GEOGRAPHIC INFORMATION SYSTEM

The Huntingdon County Planning and Development Department maintains maps of over 100 features such as roads, streams and municipal boundaries (known as coverages) as part of the

Huntingdon County Geographic Information System (GIS). These maps range from county and municipal boundaries to the detailed location information used in 911 addressing.

In 2003 the following GIS mapping services were provided: dental and medical facility locations for Telehealth; cemetery locations for the Huntingdon County Historical Society; sewage system location for the Shirley Home; Enterprise Zone location for a State grant application; Huntingdon and Smithfield area map for the Visitor's Bureau Annual Raystown Guide; and maps for the Riverview Business Center's Wellhead Protection Project.

DIGITAL PARCEL MAPPING

The Planning and Development Department obtained \$20,000 to fund the conversion of tax maps from paper to digital. Phase I of this project was completed in 2003 with the mapping of 12,938 tax parcels - 3,541 by Tax Assessment staff and 9,397 by the consultant, RTC of State College.

The Tax Assessment Office has purchased GIS software to maintain the new maps. With the completion of Phase II in 2004, all 26,636 tax parcels will be in digital form.

911 AND RURAL ADDRESSING

2003 marked issuance of addresses for the Alexandria and Petersburg postal delivery areas in Region 2, which includes Porter, Logan, West, Barree and Jackson Townships and Alexandria and Petersburg Boroughs. This area includes the Alexandria, Petersburg and Huntingdon postal delivery areas. A total of 4,336 structures were identified in Region 2; of these, 2,619 were addressable. Addressable structures include residential, business, industrial, and seasonal structures.

Presently, field work is nearing completion in Regions 3 and 6. Region 3 includes Miller, Henderson, Oneida, Smithfield, Walker, Juniata, Penn, Lincoln and Hopewell Townships and Huntingdon and Marklesburg Boroughs. Region 6 includes Shirley, Cromwell, Tell, Dublin, Clay and Springfield Townships and Mount Union, Rockhill, Orbisonia, Shade Gap, Three Springs, and Saltillo Boroughs. It is anticipated that addresses will be issued for Regions 3 and 6 by Summer of 2004 and that field work for Regions 4 and 5 will be completed by the end of 2004.

INFORMATION TECHNOLOGY

Planning and Development staff were called on to assist the County Commissioners with development of a broadband computer network for the Huntingdon County Courthouse. Staff reviewed network specifications for a 802.11g wireless network, which will enable Courthouse offices to connect to the Internet, use e-mail and share GIS data.

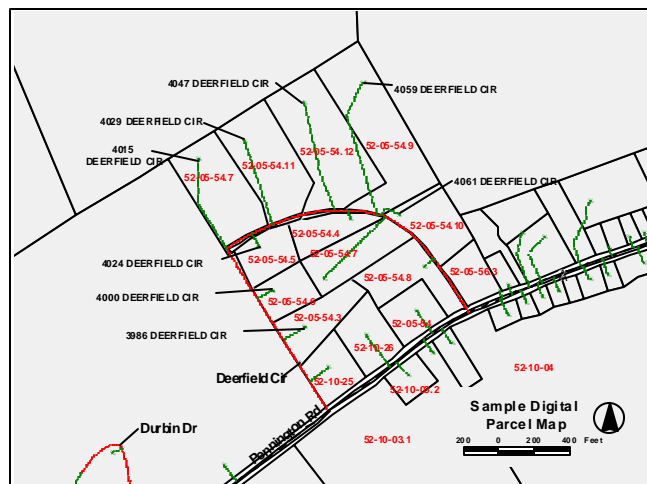

GRANT ADMINISTRATION

In 2003, Huntingdon County entered into contracts for Miscellaneous and Community Development Block Grants totaling \$810,000. The table at the bottom of the page details each miscellaneous grant awarded. Tables on page 13 record CDBG usage during the past three years and planned allocations for three future years.

The distribution of CDBG funds is described below. The greatest percentage is set aside to construct laterals to new sewer systems for low and moderate income households.

Six Year CDBG Distribution Record

Category	# of Projects Funded	%	Amount Budgeted	%
Sewer	6	28	\$677,582	48
Water	3	14	\$197,000	14
Seniors	3	14	\$227,420	16
Housing	3	14	\$88,500	6
Accessibility	2	10	\$60,000	4
Recreation	1	5	\$58,000	4
Stormwater	1	5	\$48,000	3
Ec. Dev.	1	5	\$40,000	3
Sidewalks	1	5	\$25,000	2
Totals	21	100	\$1,421,502	100

LOCAL GOVERNMENT GRANT - HUNTINGDON COUNTY ARTS COUNCIL

In cooperation with the Huntingdon County Arts Council, the Department administered a \$2,939 Local Government Grant for art activities in 2003. Matching grant contributions were made by the County and many municipalities for a \$5,878 program.

RECYCLING AND SOLID WASTE

The Recycling Coordinator provides educational programs for all Huntingdon County Schools and major events that occur within Huntingdon County.

During 2003, the Recycling Coordinator prepared several reports and grant applications: the County's Solid Waste Annual Report, a DEP 903 Grant for Recycling Coordinator expenses, a 902 Grant for educational programs and materials, and a DEP 904 Grant for materials that were recycled in 2002 through the Bedford-Fulton-Huntingdon County Recycling Program.

Three special events were held at the Huntingdon County Fairgrounds - Spring and Fall magazine, plastic and corrugated cardboard collections and a Fall Household Hazardous Waste and Tire Collection.

A total of 13.2 tons of magazines, 1 ton of plastic, 1/2 ton of corrugated cardboard, 6,523 pounds of household hazardous waste, and 75 tires were collected.

OTHER COUNTY ASSISTANCE

The Grant Administrator continues to serve on both the County Safety and Social Committees, and the Planning Technician and Grant Administrator continue to serve as members of the Huntingdon County Human Services Council.

Planning and Development staff provided assistance to the Huntingdon County Library, developing plans and bid specifications for roof replacement at the Main Library in Huntingdon. Staff assisted the Commissioners in dealing with a malfunctioning septic system at the Shirley Home.

Miscellaneous Grants			
Appalachian Regional Commission			
2003	Leadership Huntingdon County		\$10,000
Pennsylvania Council on the Arts			
2003	Local Government Grant - Huntingdon County Arts Council		\$2,939
Pennsylvania Department of Community and Economic Development			
2003	Emergency Shelter Grant Program - Huntingdon House		\$250,000
2003	TANF Housing Collaboration - Housing Rehab, Minor Home Repair		\$227,000
Southern Alleghenies Planning and Development Commission			
2003	Municipal Technical Assistance Program (MTAP)		\$8,159
League of Women Voters			
2003	Water Resources Education Network (WREN)		\$4,000
Pennsylvania Department of Agriculture			
2003	Department of Agriculture - Parcel Mapping Grant Phase II		\$10,000

Recent Competitive CDBG Funding	Year	Amount
Dudley-Carbon-Coalmont Sewer System	2002	\$500,000

CDBG Usage—Past Three Years	2001	2002	2003
Shoup’s Run Stormwater	\$48,000	0	0
Broad Top City Water	\$50,000	0	0
Dudley Water *	\$50,000	0	0
Warriors Mark Seniors*	\$66,000	0	0
Habitat for Humanity*	\$19,500	\$12,000	0
Shirley Home for the Aged Roof**	\$13,420	\$90,000	0
Mount Union Borough Elevator Feasibility Study	0	\$15,000	0
Broad Top City Borough Water and Sewer Extensions to KOEZ **	0	\$40,000	0
Dudley Sewer Laterals	0	\$85,553	\$199,241
Mount Union Sidewalks	0	0	\$25,000
Mapleton Drying Shed	0	0	\$20,000
Past Three Years Totals	\$246,920	\$242,553	\$244,241

** activity complete * activity underway

CDBG Usage - Next Three Years	2004	2005	2006
Huntingdon House Shelter	\$37,000	0	0
Alexandria Water Line Replacement	\$97,000	0	0
Orbisonia-Rockhill Homecoming Assoc. Facility Improvements	\$58,000	0	0
Petersburg Borough Sewer Pump Replacement	\$55,788	\$37,000	0
Huntingdon Habitat for Humanity	0	\$20,000	0
Puttstown Sewer Laterals	0	\$60,000	0
Juniata Valley Senior Citizens Center Addition	0	\$58,000	0
Cromwell Township Laterals	0	\$45,000	\$57,000
Huntingdon County Main Library Accessibility	0	0	\$45,000
Mill Creek Sewer Laterals/Tap Fees	0	0	\$118,000
Next Three Years Totals	\$247,788	\$220,000	\$220,000

DATA MANAGEMENT AND ANALYSIS

Proper maintenance and implementation of the *Huntingdon County Comprehensive Plan* requires continuous data collection and analysis. Data collected by the Planning Staff includes:

- ⇒ Building and Subdivision Activity
- ⇒ Deed Transfers
- ⇒ Municipal Contacts
- ⇒ Municipal Land Use Ordinances
- ⇒ Population and Socio-Economic Characteristics

SUBDIVISION ACTIVITY 1994 - 2003

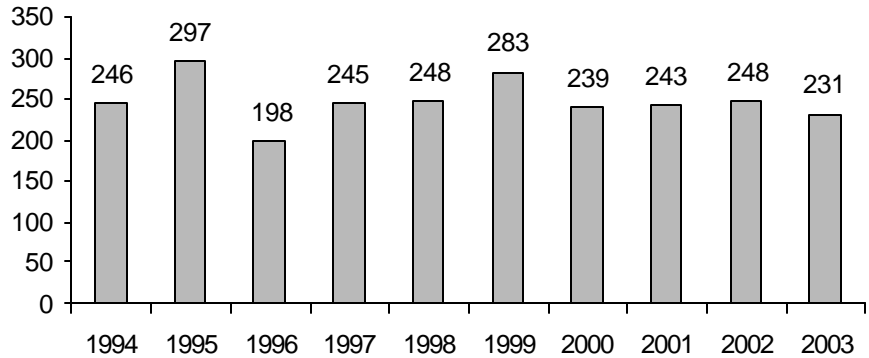

SUBDIVISION ACTIVITY

The number of new subdivision lots recorded indicates the level of land development occurring within the County. This information is valuable when determining the need for public services. Subdivision activity reflects the actual number of deeds recorded in the Courthouse (sale of lots) rather than the platting of lots referenced in the Coordination section.

During 2003, 231 new lots were recorded in Huntingdon County. This is a decrease of 6.85% from the 248 lots created in 2002.

In 2002, the highest level of activity occurred in Union Township - 34 new lots. The table below shows the highest levels in 2003 and the map on this page illustrates the intensity of development experienced in each municipality in 2003.

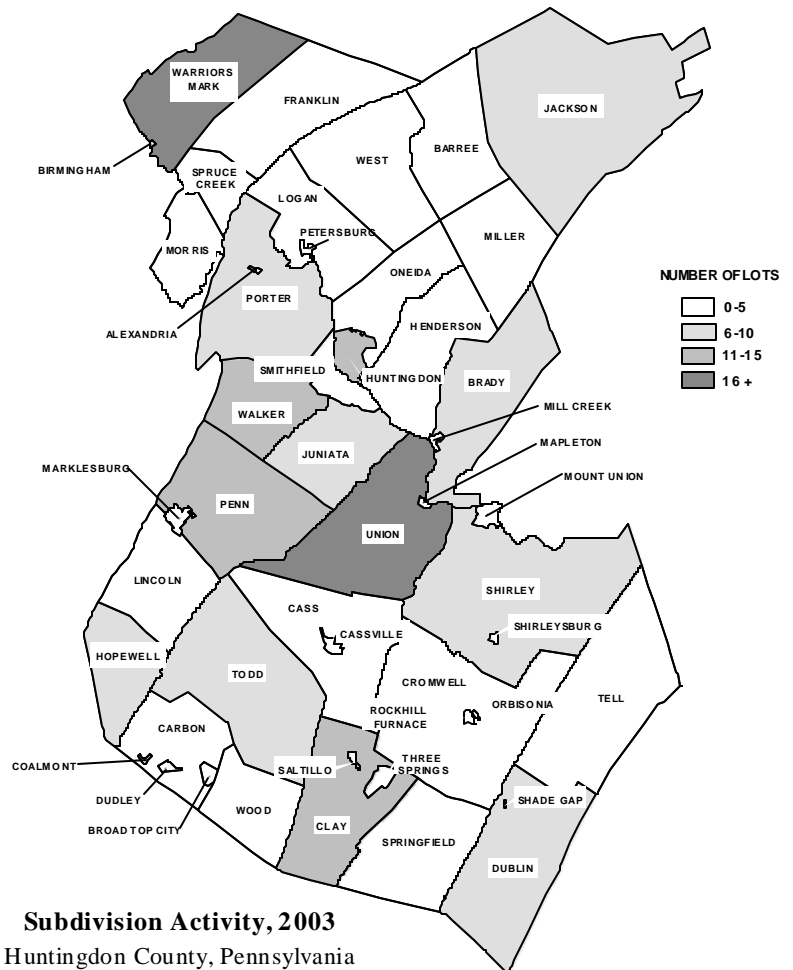

Municipality	New Lots
Warriors Mark Township	37
Union Township	33
Walker Township	14
Clay Township	12
Huntingdon Borough	12
Penn Township	11

DEED TRANSFERS

The number of deeds transferred for both new and existing properties is monitored as an indicator of the economic well being of the County. The chart on this page illustrates the number of deeds transferred over the past ten years.

The Huntingdon County Register and Recorder's Office reported that the total number of deeds transferred in 2003, both existing and new, showed a 8.45% increase from 1,585 in 2002 to 1,719 in 2003, apparently reflecting mortgage refinancing due to low interest rates.

DEED TRANSFERS 1994 - 200

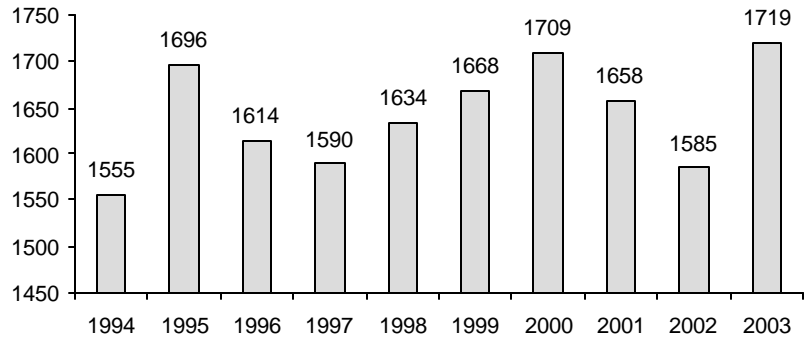

BUILDING ACTIVITY

The number of new houses constructed is measured annually. The Department uses electrical permits, from Valley Rural Electric Cooperative, and building permits, as reported to the Huntingdon County Tax Assessment Office, to estimate new housing starts. In 2003, the number of new houses constructed, 231, decreased 1.73% from the 235 in 2002.

A ten-year housing starts trend is illustrated in the chart on page 16. The map on this page illustrates the level of building activity in each municipality in 2003.

Following are the municipalities that led the County in new housing starts:

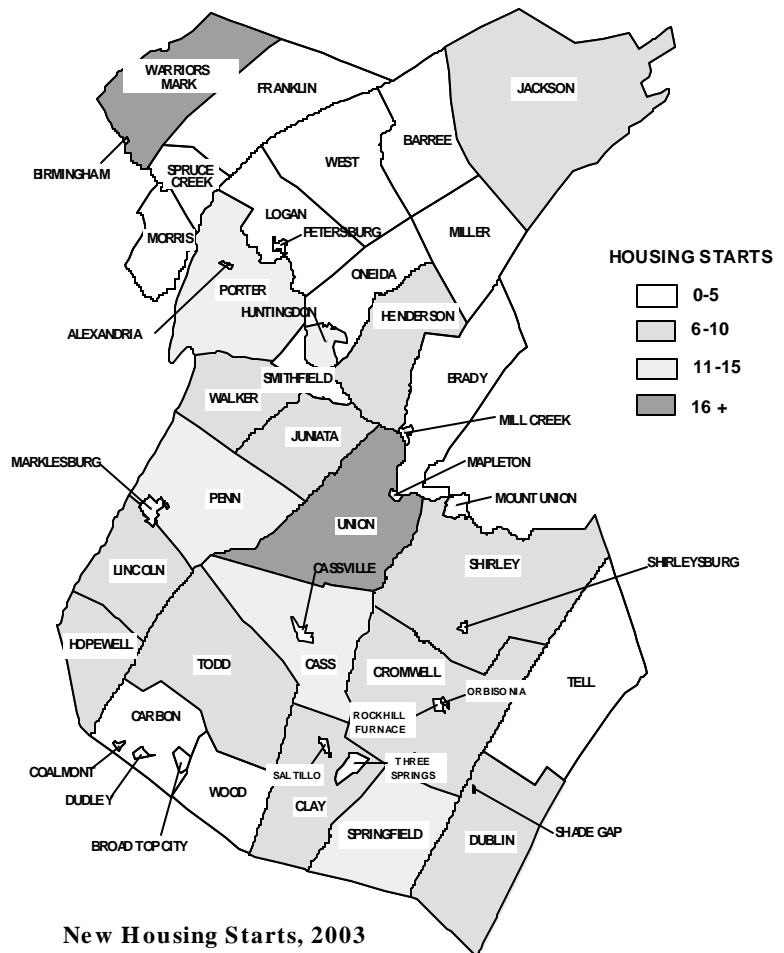

New Housing Starts, 2003
Huntingdon County, Pennsylvania

Municipality	New Homes
Union Township	18
Warriors Mark Township	16
Cass Township	13
Porter Township	13
Huntingdon Borough	12
Penn Township	12
Springfield Township	11

NEW HOUSING STARTS 1994-2003

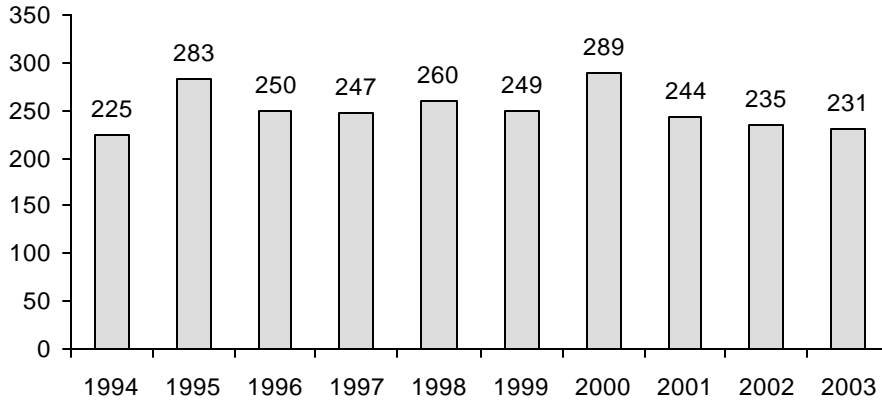

SEASONAL AND YEAR-ROUND HOUSING

The housing data also allows a comparison between seasonal and year-round housing starts. Based on Valley Rural data, 51 units, or 22% of new housing activity in 2003 involved seasonal housing. This is a decrease of 15% from 60 seasonal units in 2002. Year-round housing activity decreased by 1%, from 103 units in 2002 to 102 units in 2003.

Following are the municipalities that led the County in seasonal and year-round housing starts:

Seasonal Housing:

Municipality	New Homes
Union Township	12
Cass Township	8
Todd Township	6
Penn Township	5

Year-Round Housing:

Municipality	New Homes
Dublin Township	10
Shirley Township	9
Penn Township	7
Jackson Township	7
Union Township	6
Springfield Township	6
Henderson Township	6
Walker Township	5
Hopewell Township	5
Cromwell Township	5
Cass Township	5

PUBLIC EDUCATION AND INFORMATION

It is a goal of the Planning Commission to provide information to the public concerning planning and development issues as well as local trends in growth and development. Staff fulfills this responsibility through the various methods listed below.



PUBLICATIONS

The Planning and Development Department published several items in 2003:

- ⇒ *2002 HCPC Annual Report;*
- ⇒ *2003 Huntingdon County Land Development Guide;*
- ⇒ *Huntingdon County Comprehensive Economic Analysis*
- ⇒ *Huntingdon County Comprehensive Economic Analysis Executive Summary;*
- ⇒ *Huntingdon County Technology and Health Access Study;*

- ⇒ *Huntingdon County Transportation Needs Assessment;*
- ⇒ *2003 Huntingdon County Comprehensive Plan Implementation Report*

PUBLIC SPEAKING

The Planning Director spoke to a Juniata Valley High School class on the linkage between water quality and local government; participated in two interviews concerning Leadership Huntingdon County (Adelphia's TV 17 "Spotlight" program and on WTAJ Channel 10) ; spoke to the Mount Union Community Action Partnership and Huntingdon Rotary Club regarding Leadership Huntingdon County; and spoke to the Healthy Communities Partnership about the Transportation Needs Analysis.

The Grant Administrator conducted a Powerpoint presentation at a public meeting regarding the Mapleton Pool and availability of grant funds for repairs.

The Planning Director coordinated a series of newspaper articles with the Executive Director of the Juniata College Center for Entrepreneurial Leadership and *The Daily News* regarding the *Huntingdon County Comprehensive Economic Analysis*.

The Planning Technician and Grant Administrator continue to conduct Courthouse tours for local schools, churches and civic groups.

WALK-IN REQUESTS FOR INFORMATION

The Department receives an average of two inquiries per day concerning:

- ⇒ Census Data
- ⇒ Municipal Contacts and Ordinances
- ⇒ Flood Plain Data
- ⇒ Planning Studies
- ⇒ Grant Availability
- ⇒ Recycling Information
- ⇒ County and Municipal Maps
- ⇒ GIS Data

Most of these requests came from municipal officials, realtors, professional market analysts, residents of Huntingdon County, and those interested in relocating to Huntingdon County.

HUNTINGDONCOUNTY.NET

Planning and Development staff unveiled a totally new County web site in 2003 in cooperation with Southern Alleghenies Planning and Development Commission. The site features new home page graphics and navigation.

The new web site uses Digital Site Framework (DSF) technology. DSF is designed to allow local staff to manage the content of their own web sites without the aid of a web developer. The County web address will continue to be www.huntingdoncounty.net, which was first published in March of 2000.

Training was provided by PPT Technologies, Inc. of Lancaster, developers of DSF. DSF was developed by PPT for the State and drives most Commonwealth web sites.

PLANNING AND DEVELOPMENT DEPARTMENT STAFF

HUNTINGDON COUNTY COMMISSIONERS

Roy E. Thomas, Chairman

Charles L. States, Vice Chairman

R. Dean Fluke, Secretary

PLANNING COMMISSION MEMBERS

Ron Rabena, Chairman
Larry Mutti, Vice Chairman
Ginny Gill, Secretary

Larry Pruss
Ann Kyper Reynolds
Mildred Rockwell
Herb Cole
Carl Jaymes
Gregory Schneider

Richard E. Stahl,
Planning Director

Maureen H. Safko,
Planner/Grants Administrator

D. Brian Young,
Planner/GIS Technician

Peggy Ann Wilson,
Secretary/Bookkeeper

Sally Ann States,
Planning Technician

Laurie J. Nearhood,
Secretary

Lou Ann Shontz,
Recycling Coordinator

Cinnamon L. Bair,
Addressing Technician

Timothy J. Nabozny,
Addressing Technician

2003 Interns

Wendy Covert
Kristin Corbin
Megan Summers

Huntingdon County Planning Commission
205 Penn Street, Suite 3
Huntingdon, PA 16652

PLACE
STAMP
HERE